

ATTACHMENT FOR ST SERIES(CA4-ATMST-01) Installation Guide

Introduction

This product is a conversion kit for installing ST series in place of the following target models. By using this product you can replace the current model with a new model that has smaller panel cutout dimensions.

Target Models

GP230
GP250
GP270

Packing List

Attachment x1
Gasket x1
M4 Hex nut x6 (two spares)

Item	Specified Values	
Installation Requirements	Protective Construction	Protection: Equivalent to IP65 (Front face of installed unit)
	Weight	0.2 kg or less (Attachment only)
	External Dimensions	(W)x(H)x(D) [mm] 172.0 x 127.0 x 17.0
Color	Silver metallic	
Material	Steel plate	

Installation Procedures

- Step 1. Confirm the ST unit (1), four installation fasteners (5) and moisture resistant gasket(2) are present.
- Step 2. Make sure that the moisture resistant gasket is fitted properly to the ST unit.
- Step 3. Install the gasket (4) to the attachment (3) correctly.
- Step 4. Attach the ST unit (1) to the attachment prepared in Step 3 by using the installation fasteners (5). Tighten the fastener attachment screws. The proper torque for tightening a screw to obtain a sufficient level of splash-proof is 0.5 N·m.



Do not over-tighten the fastener attachment screws or ST unit may be damaged.

- Step 5. Insert the attachment prepared in Step 4 into the cutout section of the operation panel of the target model by matching the threaded portion of the plate with the four corners of the panel.
- Step 6. Confirm the gasket is installed correctly.
- Step 7. Tighten the M4 hex nuts (6) evenly. The proper torque for tightening a nut to obtain a sufficient level of splash-proof is 0.5 N·m.



Do not over-tighten the hex nuts or the attachment may be damaged.

Disclaimer

We assume no responsibility for any losses, damages or any claims from third party resulting from the use of this product.

Head Office
Digital Electronics Corporation
8-2-52 Nanko-higashi
Suminoe-ku, Osaka 559-0031 JAPAN
Tel: +81-(0)6-6613-1101
Fax: +81-(0)6-6613-5888
URL: <http://www.proface.co.jp>

© Copyright 2004 Digital Electronics Corporation. All rights reserved.

Completed Chart

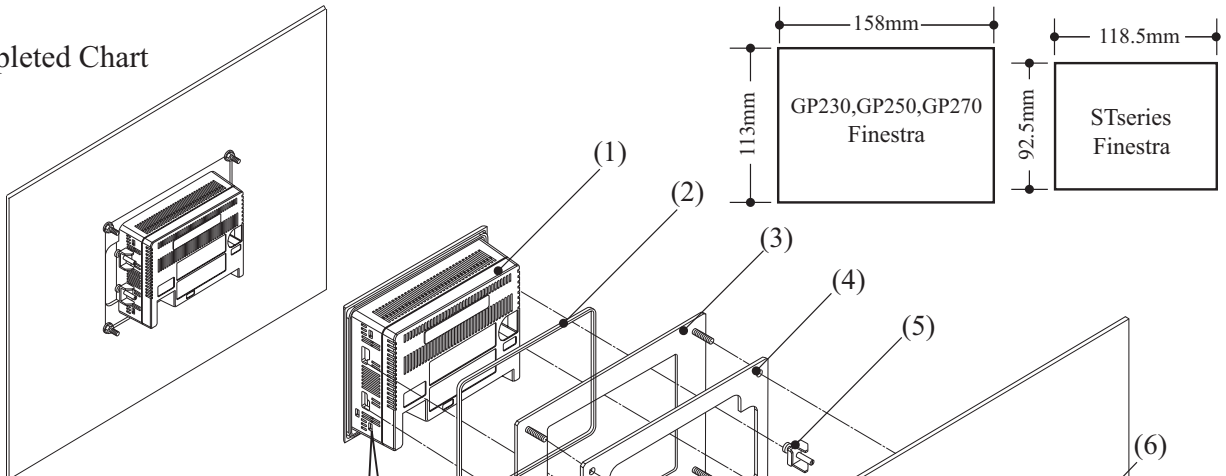

Main unit and accessories

- | | |
|------------------------------|-----------------------------------|
| ST unit x1 | (1) Option |
| Moisture resistant gasket x1 | (2) Option:Accessories of ST unit |
| Attachment x1 | (3) |
| Gasket x1 | (4) |
| Installation fastener x4 | (5) Option:Accessories of ST unit |
| M4 Hex nut x4 | (6) |

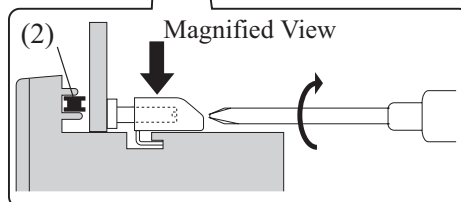

SCIGATE AUTOMATION (S) PTE LTD

No.1 Bukit Batok Street 22 #01-01 Singapore 659592

Tel: (65) 6561 0488

Fax: (65) 6562 0588

Email: sales@scigate.com.sg

Web: www.scigate.com.sg

Business Hours: Monday - Friday 8.30am - 6.15pm